

FERRULES

FERRULE SELECTION CHART.....66

STANDARD FERRULES.....70

INTERLOCK FERRULES.....74



FERRULE SELECTION CHART



H1100104 Page 70	H1100204 Page 70	H1200101 Page 71	H1200102 Page 71	H1200103 Page 71	H1200202 Page 72	H1200212 Page 72	H1200203 Page 72	H1200204 Page 73
-------------------------	-------------------------	-------------------------	-------------------------	-------------------------	-------------------------	-------------------------	-------------------------	-------------------------

NO SKIVE FERRULE FOR STANDARD INSERTS

HOSE TYPE	-03	-04	-05	-06	-08	-10	-12	-16	-20	-24	-32	-40	-48
	DN 05	DN 06	DN 08	DN 10	DN 12	DN 16	DN 19	DN 25	DN 31	DN 38	DN 52	DN 63	DN 76
	3/16"	1/4"	5/16"	3/8"	1/2"	5/8"	3/4"	1"	1 1/4"	1 1/2"	2"	2 1/2"	3"
FLEXOR 6		H1100204	H1100204	H1100204	H1100204	H1100204	H1100204	H1100204					
FLEXOR 3		H1200203	H1200203	H1200203	H1200203	H1200203	H1200203	H1200203	H1200203				
FLEXOPAK 1SC		H1200101	H1200101	H1200101	H1200101	H1200202	H1200202	H1200103	H1200102	H1200202	H1200202		
FLEXOR 1SN MSHA	H1200203	H1200102	H1200202	H1200212	H1200212	H1200202	H1200202	H1200202	H1200102	H1200202	H1200202	H1200203	C122...-48
FLEXOPAK 2SC		H1200102	H1200202	H1200212	H1200212	H1200202	H1200202	H1200202					
FLEXOR 2SN MSHA	H1200203	H1200202	H1200202	H1200212	H1200212	H1200202	H1200202	H1200202	H1200202	H1200202	H1200202		
FLEXOR 12				H1200204	H1200204	H1200204	H1200204	H1200204	H1200204				
AT3K-1B/2B		H1200101	H1200101	H1200101	H1200101	H1200202	H1200202	H1200202					
AT4K-2B			H1200202	H1200212	H1200212	H1200202							
AT4K-4S				H1200204	H1200204	H1200204	H1200204	H1200204					
AT5K-2B		H1200102	H1200202	H1200212									
FLEXOR R4							H1200203	H1200203	H1200203	H1200203	H1200203	H1200203	

HOSE TYPE	-04	-05	-06	-08	-10	-12	-16	-20	-24	-32			
	DN 05	DN 06	DN 08	DN 10	DN 12	DN 16	DN 22	DN 29	DN 35	DN 46			
	3/16"	1/4"	5/16"	13/32"	1/2"	5/8"	7/8"	1 1/8"	1 3/8"	1 13/16"			
FLEXOR R5	H1200203 -03	H1200203 -04	H1200203 -05	H1200203 -06	H1200203 -08	H1200203 -10	H1200203 -12	H1200203 -16	H1200203 -20	H1100104 -32			

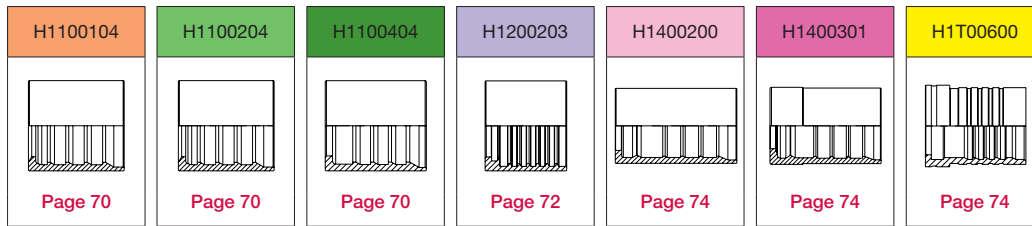

SKIVE FERRULE FOR STANDARD INSERTS

HOSE TYPE	-03	-04	-05	-06	-08	-10	-12	-16	-20	-24	-32	-40	-48	
	DN 05	DN 06	DN 08	DN 10	DN 12	DN 16	DN 19	DN 25	DN 31	DN 38	DN 52	DN 63	DN 76	
	3/16"	1/4"	5/16"	3/8"	1/2"	5/8"	3/4"	1"	1 1/4"	1 1/2"	2"	2 1/2"	3"	
FLEXOR 1SN MSHA	H1200203	H1100204	H1100204	H1100204	H1100204	H1100204	H1100204	H1100204	H1100204	H1100104	H1100104	H1100104		
FLEXOR 2SC		H1100204	H1100204	H1100204	H1100204	H1100204	H1100204	H1100204	H1100204					
FLEXOR 2SN MSHA	H1200203	H1100204	H1100204	H1100204	H1100204	H1100204	H1100204	H1100204	H1100204	H1100204	H1100204	H1200203	C122...-48	
FLEXOR 2ST MSHA	H1200203	H1100204	H1100204	H1100204	H1100204	H1100204	H1100204	H1100204	H1100204	H1100204	H1100204	H1200203	C122...-48	
FLEXOR R12				H1100404	H1100404	H1100204	H1100204	H1100204	H1100204	H1100204	H1100204			
FLEXOR 4SP		H1100404		H1100404	H1100404	H1100404	H1100404	H1100204						
AT3K-2B/4S						H1100204	H1100204	H1100204	H1100204					
AT4K-2B					H1100204	H1100204	H1100204							
AT4K-4S				H1100404	H1100404	H1100204	H1100204	H1100204	H1100204					
AT5K-2B			H1100204	H1100204	H1100204	H1100204								
AT5K-4S						H1100404	H1100404							
AT6K-4S		H1100404		H1100404	H1100404									

INTERLOCK FERRULE FOR INTERLOCK INSERTS

HOSE TYPE				-06	-08	-10	-12	-16	-20	-24	-32	-40	
				DN 10	DN 12	DN 16	DN 19	DN 25	DN 31	DN 38	DN 52	DN 63	
				3/8"	1/2"	5/8"	3/4"	1"	1 1/4"	1 1/2"	2"	2 1/2"	
FLEXOR R12					H1400200	H1400200	H1400200	H1400200	H1400200	H1400200	H1400200	H1400301	
FLEXOR R13							H1400200	H1400200	H1400301	H1400301	H1400301		
FLEXOR 4SP				H1400200	H1400200	H1400200	H1400200	H1400200					
FLEXOR 4SH							H1400200	H1400200	H1400200	H1400200	H1400200		
AT4K-4S					H1400200	H1400200	H1400200	H1400200	H1400200	H1400200	H1400200		
AT5K-4S						H1400200	H1400200	H1400200	H1400200	H1400200			
AT5K-6S									H1400301	H1400301	H1400301	H1T00600	
AT6K-4S/6S				H1400200	H1400200	H1400301	H1400200	H1400200	H1400301	H1400301	H1T00600		
AT7K-4S						H1400301							
AT8K-6S							H1400301	H1400301					

FERRULES - STANDARD

HYDRAULIC
HOSE

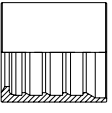

H1100104
Standard Ferrule

70

INDUSTRIAL
HOSE

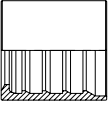

H1100204
Standard Ferrule

70

FERRULES

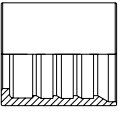

H1100404
Standard Ferrule

70

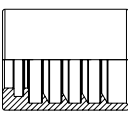

H1200101
Standard Ferrule

71

INSERTS

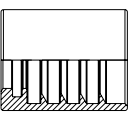

H1200102
Standard Ferrule

71

ADAPTERS

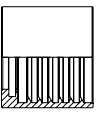

H1200103
Standard Ferrule

71

ACCESSORIES

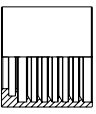

H1200202
Standard Ferrule

72

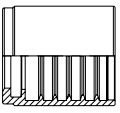

H1200212
Standard Ferrule

72

BALL VALVES

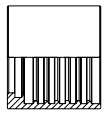

H1200203
Standard Ferrule

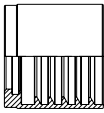

72



H1200204
Standard Ferrule

73

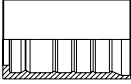
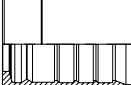
FERRULES - INTERLOCK

	<p>H1400200 Interlock Ferrule</p>	<p>74</p>
	<p>H1400301 Interlock Ferrule</p>	<p>74</p>
	<p>H1T00600 Interlock Ferrule</p>	<p>74</p>

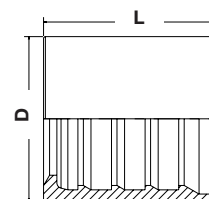
FERRULES - STANDARD**H1100104**
Standard Ferrule

PRODUCT CODE	TYPE	HOSE BORE			DIMENSIONS		HOSE TYPE
		DN	INCH	DASH	D mm	L mm	
H1100104-200000	STD	DN 31	1 1/4"	-20	50	43.7	1SN S
H1100104-240000	STD	DN 38	1 1/2"	-24	57	49.1	1SN S
H1100104-320000	STD	DN 51	2"	-32	71	63.6	1SN S - R5 NS

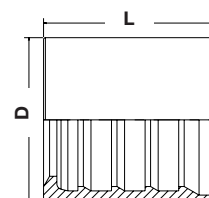
**H1100204**
Standard Ferrule

PRODUCT CODE	TYPE	HOSE BORE			DIMENSIONS		HOSE TYPE
		DN	INCH	DASH	D mm	L mm	
H1100204-040000	STD	DN 06	1/4"	-04	21	26.3	1SN/2SN/2SC/AJ400 S - R6/2TE NS
H1100204-050000	STD	DN 08	5/16"	-05	22	26.5	1SN/2SN/2SC/AT5K/AJ400 S - R6/2TE NS
H1100204-060000	STD	DN 10	3/8"	-06	25	28.5	1SN/2SN/2SC/AT5K/AJ400 S - R6/2TE NS
H1100204-080000	STD	DN 12	1/2"	-08	29	34.7	1SN/2SN/2SC/AT4K/AT5K/FXP3/AJ400 S - R6/2TE NS
H1100204-100000	STD	DN 16	5/8"	-10	32	37.5	1SN/2SN/2SC/AT3K/AT4K/R12/AT5K/FXP3 S - R6/2TE NS
H1100204-120000	STD	DN 19	3/4"	-12	36	41.5	1SN/2SN/2SC/AT3K/AT4K/R12/FXP3 S - R6/2TE NS
H1100204-160000	STD	DN 25	1"	-16	45	47.7	1SN/2SN/2SC/AT3K/AT4K/R12/4SP/FXP3 S - R6/2TE NS
H1100204-200000	STD	DN 31	1 1/4"	-20	58	54.6	2SN/AT3K/AT4K/R12 S
H1100204-240000	STD	DN 38	1 1/2"	-24	67	61.1	2SN/R12 S
H1100204-320000	STD	DN 51	2"	-32	82	75.1	2SN/R12 S

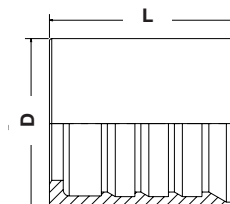
**H1100404**
Standard Ferrule

PRODUCT CODE	TYPE	HOSE BORE			DIMENSIONS		HOSE TYPE
		DN	INCH	DASH	D mm	L mm	
H1100404-040000	STD	DN 06	1/4"	-04	22	26.3	4SP/AT6K S
H1100404-060000	STD	DN 10	3/8"	-06	25	28.5	4SP/R12/AT4K/AT6K S
H1100404-080000	STD	DN 12	1/2"	-08	29	34.7	4SP/R12/AT4K/AT6K/FXP3 S
H1100404-100000	STD	DN 16	5/8"	-10	33	37.5	4SP/AT5K S
H1100404-120000	STD	DN 19	3/4"	-12	37	41.5	4SP/AT5K S



H1200101
Standard Ferrule

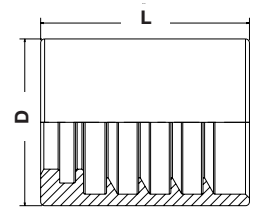

PRODUCT CODE	TYPE	HOSE BORE			DIMENSIONS		HOSE TYPE
		DN	INCH	DASH	D mm	L mm	
H1200101-040000	STD	DN 06	1/4"	-04	19	26.3	1SC/AT3K/AJ210 NS
H1200101-050000	STD	DN 08	5/16"	-05	21	26.3	1SC/AT3K/AJ210 NS
H1200101-060000	STD	DN 10	3/8"	-06	23	27.2	1SC/AT3K/AJ210 NS
H1200101-080000	STD	DN 12	1/2"	-08	27	32.8	1SC/AT3K/AJ210 NS



H1200102
Standard Ferrule

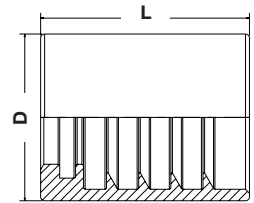

PRODUCT CODE	TYPE	HOSE BORE			DIMENSIONS		HOSE TYPE
		DN	INCH	DASH	D mm	L mm	
H1200102-040000	STD	DN 06	1/4"	-04	21	26.3	1SN/2SC/AT5K/FXP16/AJ400 NS
H1200102-200000	STD	DN 31	1 1/4"	-20	55	39.9	1SN/FXP16 NS



H1200103
Standard Ferrule

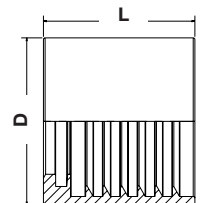

PRODUCT CODE	TYPE	HOSE BORE			DIMENSIONS		HOSE TYPE
		DN	INCH	DASH	D mm	L mm	
H1200103-040000	STD	DN 06	1/4"	-04	19	26.3	FXP PLT NS
H1200103-050000	STD	DN 08	5/16"	-05	21	26.3	FXP PLT NS
H1200103-060000	STD	DN 10	3/8"	-06	22	27.2	FXP PLT NS
H1200103-080000	STD	DN 12	1/2"	-08	25	32.8	FXP PLT NS
H1200103-160000	STD	DN 25	1"	-16	42	45.3	1SC NS

FERRULES - STANDARD

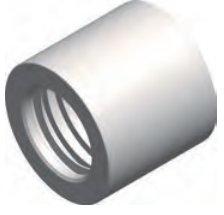

H1200202
Standard Ferrule

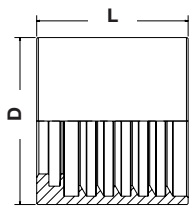

PRODUCT CODE	TYPE	HOSE BORE			DIMENSIONS		HOSE TYPE
		DN	INCH	DASH	D mm	L mm	
H1200202-040000	STD	DN 06	1/4"	-04	22	26.3	2SN NS
H1200202-050000	STD	DN 08	5/16"	-05	25	26.3	1SN/2SN/2SC/AT4K/AT5K/FXP16/AJ400 NS
H1200202-100000	STD	DN 16	5/8"	-10	34	35.6	1SN/2SN/1SC/AT3K/AT4K/FXP16 NS
H1200202-120000	STD	DN 19	3/4"	-12	38	38.6	1SN/2SN/1SC/2SC/AT3K/FXP16 NS
H1200202-160000	STD	DN 25	1"	-16	50	45.3	1SN/2SN/2SC/AT3K/FXP16 NS
H1200202-200000	STD	DN 31	1 1/4"	-20	61	50.2	2SN NS
H1200202-240000	STD	DN 38	1 1/2"	-24	70	63.7	1SN/2SN NS
H1200202-320000	STD	DN 51	2"	-32	82	73	1SN/2SN NS



H1200212
Standard Ferrule

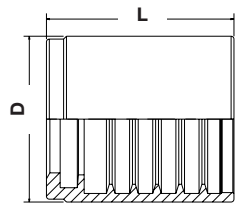

PRODUCT CODE	TYPE	HOSE BORE			DIMENSIONS		HOSE TYPE
		DN	INCH	DASH	D mm	L mm	
H1200212-060000	STD	DN 10	3/8"	-06	26	27.2	1SN/2SN/2SC/AT4K/AT5K/FXP16/AJ400 NS
H1200212-080000	STD	DN 12	1/2"	-08	29	32.8	1SN/2SN/2SC/AT4K/FXP16/AJ400 NS

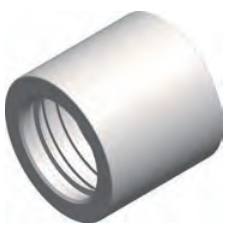

H1200203
Standard Ferrule

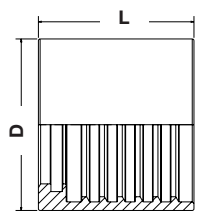

PRODUCT CODE	TYPE	HOSE BORE			DIMENSIONS		HOSE TYPE
		DN	INCH	DASH	D mm	L mm	
H1200203-030000	STD	DN 05	3/16"	-03	20	24.3	1SN/2SN/R5 NS - 1SN/2SN S
H1200203-040000	STD	DN 06	1/4"	-04	22	26.3	R3/3TE/R5 NS
H1200203-050000	STD	DN 08	5/16"	-05	25	26.3	R3/3TE/R5 NS
H1200203-060000	STD	DN 10	3/8"	-06	25	27.2	R3/3TE/R5 NS
H1200203-080000	STD	DN 12	1/2"	-08	29	32.8	R3/3TE/R5 NS
H1200203-100000	STD	DN 16	5/8"	-10	34	35.6	R3/3TE/R5 NS
H1200203-120000	STD	DN 19	3/4"	-12	38	38.6	R3/3TE/R4/R5 NS
H1200203-160000	STD	DN 25	1"	-16	50	45.3	R3/3TE/R4/R5 NS
H1200203-200000	STD	DN 31	1 1/4"	-20	51	49	R3/R4/R5 NS
H1200203-240000	STD	DN 38	1 1/2"	-24	60.3	56	R4/R5 NS
H1200203-320000	STD	DN 51	2"	-32	76.1	69	R4 NS
H1200203-400000	STD	DN 63	2 1/2"	-40	88.9	85	2ST/R4 NS



H1200204

Standard Ferrule

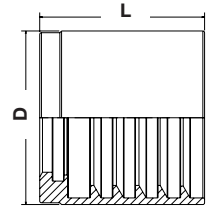

PRODUCT CODE	TYPE	HOSE BORE			DIMENSIONS		HOSE TYPE
		DN	INCH	DASH	D mm	L mm	
H1200204-060000	STD	DN 10	3/8"	-06	30	28	R12/AT4K NS
H1200204-080000	STD	DN 12	1/2"	-08	34	33.9	R12/AT4K NS
H1200204-100000	STD	DN 16	5/8"	-10	38	36.6	R12/AT4K NS
H1200204-120000	STD	DN 19	3/4"	-12	42	39.5	R12/AT4K NS
H1200204-160000	STD	DN 25	1"	-16	50	45.4	R12/AT4K NS
H1200204-200000	STD	DN 31	1 1/4"	-20	62	50.1	R12/AT3K NS

FERRULES - INTERLOCK



H1400200
Interlock Ferrule

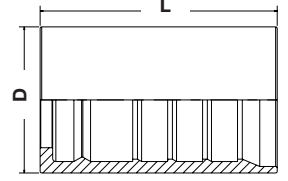

PRODUCT CODE	TYPE	HOSE BORE			DIMENSIONS		HOSE TYPE
		DN	INCH	DASH	D mm	L mm	
H1400200-060000	IL	DN 10	3/8"	-06	27	49	4SP/AT6K
H1400200-080000	IL	DN 12	1/2"	-08	30	52.5	4SP/R12/AT4K/AT6K
H1400200-100000	IL	DN 16	5/8"	-10	34	57.5	4SP/R12/AT4K/AT5K
H1400200-120000	IL	DN 19	3/4"	-12	38	60.1	4SP/4SH/R12/R13/AT4K/AT5K/AT6K/FXB25K
H1400200-160000	IL	DN 25	1"	-16	46	74.6	4SP/4SH/R12/R13/AT4K/AT5K/AT6K/FXB25K
H1400200-200000	IL	DN 31	1 1/4"	-20	55	88.1	4SH/R12/AT4K/AT5K
H1400200-240000	IL	DN 38	1 1/2"	-24	62	94.1	4SH/R12/AT4K/AT5K
H1400200-320000	IL	DN 51	2"	-32	78	99.1	4SH/R12/AT4K



H1400301
Interlock Ferrule

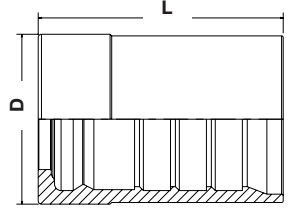

PRODUCT CODE	TYPE	HOSE BORE			DIMENSIONS		HOSE TYPE
		DN	INCH	DASH	D mm	L mm	
H1400301-100000	IL	DN 16	5/8"	-10	35.5	57.5	AT6K/AT7K
H1400301-120000	IL	DN 19	3/4"	-12	43.5	60	AT8K/FXB36K
H1400301-160000	IL	DN 25	1"	-16	52	74.8	AT8K
H1400301-200000	IL	DN 31	1 1/4"	-20	64	88.1	R13/AT5K/AT6K
H1400301-240000	IL	DN 38	1 1/2"	-24	69.5	94.1	R13/AT5K/AT6K
H1400301-320000	IL	DN 51	2"	-32	88	99.1	R13/AT5K
H1400301-400000	IL	DN 63	2 1/2"	-40	102	110	R12



H1T00600
Interlock Ferrule

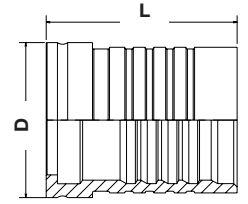

PRODUCT CODE	TYPE	HOSE BORE			DIMENSIONS		HOSE TYPE
		DN	INCH	DASH	D mm	L mm	
H1T00600-320000	IL	DN 51	2"	-32	88.1	108.2	AT6K
H1400301-400000	IL	DN 63	2 1/2"	-40	109	134.1	AT5K

INSERTS

RAPID STAPLE-LOCK INSERTS
STANDARD 78

RAPID STAPLE-LOCK INSERTS
INTERLOCK 80

SUPER RAPID STAPLE-LOCK
INSERTS - INTERLOCK 81

COMPACT INSERTS
STANDARD 82

COMPACT INSERTS
INTERLOCK 83

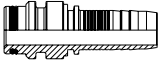
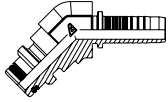
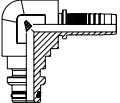
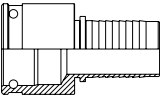

RAPID STAPLE-LOCK INSERTS - STANDARD

	H1214810 Rapid SL Male - Straight - Standard Insert SLM STD INSERT	78
	H1214840 Rapid SL Male - 45° - Standard Insert SLM STD INSERT 45	78
	H1214890 Rapid SI Male - 90° - Standard Insert SLM STD INSERT 90	78
	H1224810 Rapid SL Female - Standard Insert SLF STD INSERT	79

RAPID STAPLE-LOCK INSERTS - INTERLOCK

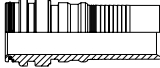
	H1414810 Rapid SL Male - Straight - Interlock Insert SLM IL INSERT	80
--	---	-----------

SUPER RAPID STAPLE-LOCK INSERTS - INTERLOCK

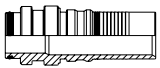
	H1414A10 Super Rapid SL Male - Straight - Interlock Insert SSLM IL INSERT	81
	H1424A10 Super Rapid SL Female - Interlock Insert SSLF IL INSERT	81
	H1424B10 Super Rapid 42 SL Female - Interlock Insert SSLF42 IL INSERT	81

COMPACT INSERTS - STANDARD

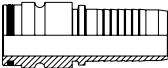
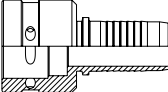
	H1213H10 Compact Male - Straight - Standard Insert CPM STD INSERT	82
	H1223H10 Compact Female - Standard Insert CPF STD INSERT	82

COMPACT INSERTS - INTERLOCK

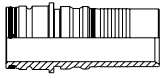

H1413H10
Compact Male - Straight - Interlock Insert
CPM IL INSERT

83

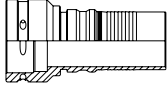

H1423H10
Compact Female - Interlock Insert
CPF IL INSERT

83



H1214810
Rapid SL Male - Straight - Standard Insert
SLM STD INSERT

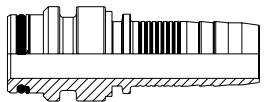

PRODUCT CODE	INSERT				T1			
	TYPE	HOSE BORE			TYPE	NOMINAL BORE		
		DN	INCH	DASH		DN	INCH	DASH
H1214810-040400	STD	DN 06	1/4"	-04	SL M	DN 06	1/4"	-04
H1214810-040600	STD	DN 06	1/4"	-04	SL M	DN 10	3/8"	-06
H1214810-060600	STD	DN 10	3/8"	-06	SL M	DN 10	3/8"	-06
H1214810-060800	STD	DN 10	3/8"	-06	SL M	DN 12	1/2"	-08
H1214810-080800	STD	DN 12	1/2"	-08	SL M	DN 12	1/2"	-08
H1214810-121200	STD	DN 19	3/4"	-12	SL M	DN 19	3/4"	-12
H1214810-161600	STD	DN 25	1"	-16	SL M	DN 25	1"	-16
H1214810-202000	STD	DN 31	1 1/4"	-20	SL M	DN 31	1 1/4"	-20
H1214810-242400	STD	DN 38	1 1/2"	-24	SL M	DN 38	1 1/2"	-24
H1214810-323200	STD	DN 51	2"	-32	SL M	DN 51	2"	-32
H1214810-484800	STD	DN 76	3"	-48	SL M	DN 76	3"	-48



H1214840
Rapid SL Male - 45° - Standard Insert
SLM STD INSERT 45

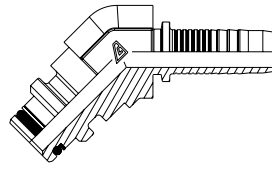

PRODUCT CODE	INSERT				T1			
	TYPE	HOSE BORE			TYPE	NOMINAL BORE		
		DN	INCH	DASH		DN	INCH	DASH
H1214840-060600	STD	DN 10	3/8"	-06	SL M	DN 10	3/8"	-06
H1214840-080800	STD	DN 12	1/2"	-08	SL M	DN 12	1/2"	-08



H1214890
Rapid SL Male - 90° - Standard Insert
SLM STD INSERT 90

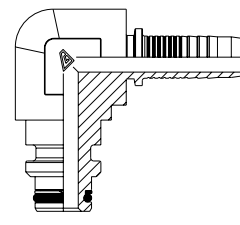

PRODUCT CODE	INSERT				T1			
	TYPE	HOSE BORE			TYPE	NOMINAL BORE		
		DN	INCH	DASH		DN	INCH	DASH
H1214890-060600	STD	DN 10	3/8"	-06	SL M	DN 10	3/8"	-06
H1214890-080800	STD	DN 12	1/2"	-08	SL M	DN 12	1/2"	-08



H1224810
Rapid SL Female - Standard Insert
SLF STD INSERT

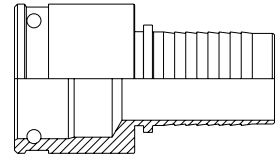

PRODUCT CODE	INSERT				T1			
	TYPE	HOSE BORE			TYPE	NOMINAL BORE		
		DN	INCH	DASH		DN	INCH	DASH
H1224810-242400	STD	DN 38	1 1/2"	-24	SL F	DN 38	1 1/2"	-24
H1224810-323200	STD	DN 51	2"	-32	SL F	DN 51	2"	-32



H1414810

Rapid SL Male - Straight - Interlock Insert
SLM IL INSERT

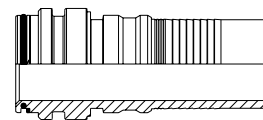

PRODUCT CODE	INSERT				T1			
	TYPE	HOSE BORE			TYPE	NOMINAL BORE		
		DN	INCH	DASH		DN	INCH	DASH
H1414810-121200	IL	DN 19	3/4"	-12	SL M	DN 19	3/4"	-12
H1414810-161600	IL	DN 25	1"	-16	SL M	DN 25	1"	-16
H1414810-202000	IL	DN 31	1 1/4"	-20	SL M	DN 31	1 1/4"	-20
H1414810-242400	IL	DN 38	1 1/2"	-24	SL M	DN 38	1 1/2"	-24
H1414810-323200	IL	DN 51	2"	-32	SL M	DN 51	2"	-32



H1414A10

Super Rapid SL Male - Straight Interlock Insert
SSLM IL INSERT

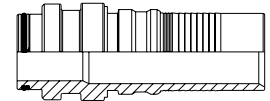

PRODUCT CODE	INSERT				T1			
	TYPE	HOSE BORE			TYPE	NOMINAL BORE		
		DN	INCH	DASH		DN	INCH	DASH
H1414A10-080800	IL	DN 12	1/2"	-08	SSL M	DN 12	1/2"	-08
H1414A10-121200	IL	DN 19	3/4"	-12	SSL M	DN 19	3/4"	-12
H1414A10-161600	IL	DN 25	1"	-16	SSL M	DN 25	1"	-16
H1414A10-202000	IL	DN 31	1 1/4"	-20	SSL M	DN 31	1 1/4"	-20
H1414A10-242400	IL	DN 38	1 1/2"	-24	SSL M	DN 38	1 1/2"	-24
H1414A10-323200	IL	DN 51	2"	-32	SSL M	DN 51	2"	-32



H1424A10

Super Rapid SL Female - Interlock Insert
SSLF IL INSERT

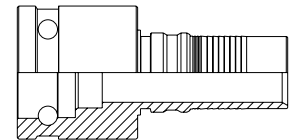

PRODUCT CODE	INSERT				T1			
	TYPE	HOSE BORE			TYPE	NOMINAL BORE		
		DN	INCH	DASH		DN	INCH	DASH
H1424A10-080800	IL	DN 12	1/2"	-08	SSL F	DN 12	1/2"	-08
H1424A10-121200	IL	DN 19	3/4"	-12	SSL F	DN 19	3/4"	-12
H1424A10-161600	IL	DN 25	1"	-16	SSL F	DN 25	1"	-16
H1424A10-202000	IL	DN 31	1 1/4"	-20	SSL F	DN 31	1 1/4"	-20
H1424A10-242400	IL	DN 38	1 1/2"	-24	SSL F	DN 38	1 1/2"	-24
H1424A10-323200	IL	DN 51	2"	-32	SSL F	DN 51	2"	-32



H1424B10

Super Rapid 42 SL Female - Interlock Insert
SSLF42 IL INSERT

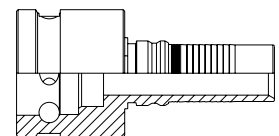

PRODUCT CODE	INSERT				T1			
	TYPE	HOSE BORE			TYPE	NOMINAL BORE		
		DN	INCH	DASH		DN	INCH	DASH
H1424B10-242442	IL	DN 38	1 1/2"	-24	SSL F	DN 38	1 1/2"	-24
H1424B10-323242	IL	DN 51	2"	-32	SSL F	DN 51	2"	-32



H1213H10
Compact Male - Straight - Standard Insert
CPM STD INSERT

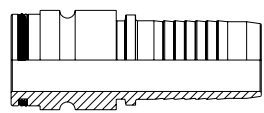

PRODUCT CODE	INSERT				T1			
	TYPE	HOSE BORE			TYPE	NOMINAL BORE		
		DN	INCH	DASH		DN	INCH	DASH
H1213H10-202000	STD	DN 31	1 1/4"	-20	CP M	DN 31	1 1/4"	-20
H1213H10-242400	STD	DN 38	1 1/2"	-24	CP M	DN 38	1 1/2"	-24
H1213H10-323200	STD	DN 51	2"	-32	CP M	DN 51	2"	-32
H1213H10-404000	STD	DN 63	2 1/2"	-40	CP M	DN 63	2 1/2"	-40



H1223H10
Compact Female - Standard Insert
CPF STD INSERT

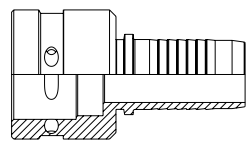

PRODUCT CODE	INSERT				T1			
	TYPE	HOSE BORE			TYPE	NOMINAL BORE		
		DN	INCH	DASH		DN	INCH	DASH
H1223H10-202000	STD	DN 31	1 1/4"	-20	CP F	DN 31	1 1/4"	-20
H1223H10-242400	STD	DN 38	1 1/2"	-24	CP F	DN 38	1 1/2"	-24
H1223H10-323200	STD	DN 51	2"	-32	CP F	DN 51	2"	-32
H1223H10-404000	STD	DN 63	2 1/2"	-40	CP F	DN 63	2 1/2"	-40